

TOLSEN FORCE XPRESS

88553 DEMOLITION HAMMER

INSTRUCTION MANUAL

1700W 230V~50HZ

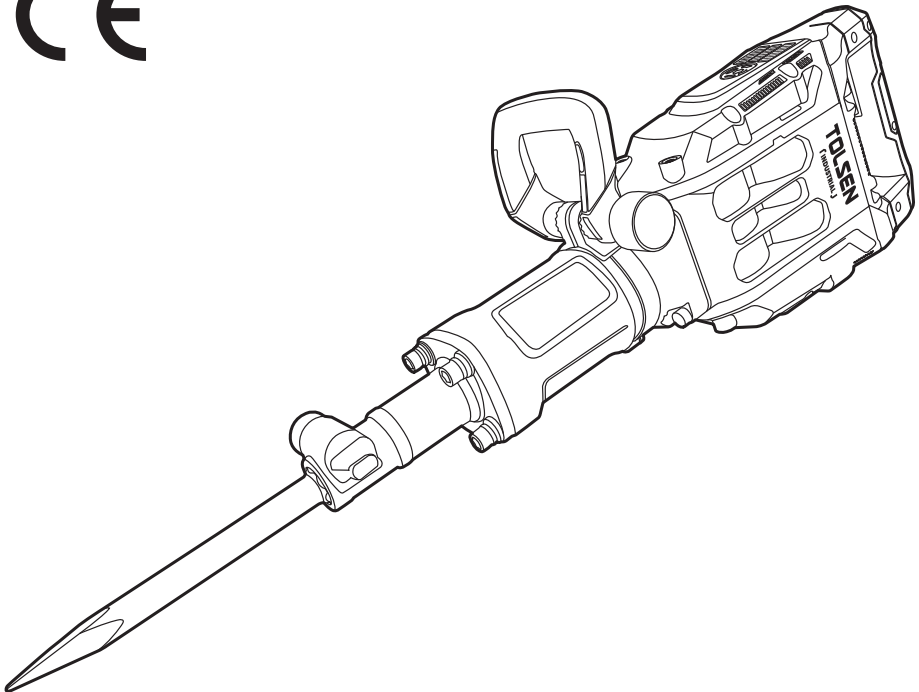

SAVE THIS MANUAL !

You will need this manual for safety instructions, operating procedures and warranty.
Put it and the original sales receipt in a safe dry place for future reference.

IMPORTANT SAFETY INFORMATION

General Power Tool Safety Warnings

WARNING:

read all safety warnings and instructions. Failure to follow the warnings and instructions may result in electric shock, fire and/or serious injury. Save all warnings and instructions for future reference. The term "power tool" in the warnings refers to your mains-operated (corded) power tool.

Work area safety

1. Keep work area clean and well lit. Cluttered or dark areas invite accidents.
2. Do not operate power tools in explosive atmospheres, such as in the presence of flammable liquids, gases or dust. Power tools create sparks which may ignite the dust or fumes.
3. Keep children and bystanders away while operating a power tool. Distractions can cause you to lose control.

Electrical safety

1. power tool plugs must match the outlet. never modify the plug in any way. Do not use any adapter plugs with grounded power tools. Unmodified plugs and matching outlets will reduce risk of electric shock.
2. avoid body contact with grounded surfaces such as pipes, radiators, ranges and refrigerators. There is an increased risk of electric shock if your body is grounded.
3. Do not expose power tools to rain or wet conditions. Water entering a power tool will increase the risk of electric shock.
4. Do not abuse the cord. never use the cord for carrying, pulling or unplugging the power tool. Keep cord away from heat, oil, sharp edges or moving parts. Damaged or entangled cords increase the risk of electric shock.
5. When operating a power tool outdoors, use an extension cord suitable for outdoor use. Use of a cord suitable for outdoor use reduces the risk of electric shock.
6. if operating a power tool in a damp location is unavoidable, use a Ground Fault circuit interrupter (GFCI) protected supply. Use of a GFCI reduces the risk of electric shock.

Personal safety

1. Stay alert, watch what you are doing and use common sense when operating a power tool. Do not use a power tool while you are tired or under the influence of drugs, alcohol or medication. A moment of inattention while operating power tools may result in serious personal injury.
2. Use personal protective equipment. always wear eye protection. Safety equipment such as dust mask, non-skid safety shoes, hard hat, or hearing protection used for appropriate conditions will reduce personal injuries.
3. Prevent unintentional starting. Ensure the trigger is in the off-position before connecting to power source, picking up or carrying the tool. Carrying power tools with your finger on the Trigger or energizing power tools that have the Trigger on invites accidents.
4. Do not overreach. Keep proper footing and balance at all times. This enables better control of the power tool in unexpected situations.
5. Dress properly. Do not wear loose clothing or jewelry. Keep your hair, clothing and gloves away from moving parts. Loose clothes, jewelry or long hair can be caught in moving parts.
6. If devices are provided for the connection of dust extraction and collection facilities, ensure these are connected and properly used. Use of these devices can reduce dust-related hazards.
7. Only use safety equipment that has been approved by an appropriate standards agency. Unapproved safety equipment may not provide adequate protection. Eye protection must be ANSI-approved and breathing protection must be NIOSH-approved for the specific hazards in the work area.

Power tool use and care

1. Do not force the power tool. use the correct power tool for your application. The correct power tool will do the job better and safer at the rate for which it was designed.
2. Do not use the power tool if the trigger does not turn it on and off. Any power tool that cannot be controlled with the Trigger is dangerous and must be repaired.
3. Disconnect the plug from the power source before making any adjustments, changing accessories, or storing power tools. Such preventive safety measures reduce the risk of starting the power tool accidentally.
4. Store idle power tools out of the reach of children and do not allow persons unfamiliar with the power tool or these instructions to operate the power tool. Power tools are dangerous in the hands of untrained users.
5. Maintain power tools. check for misalignment or binding of moving parts, breakage of parts and any other condition that may affect the power tool's operation. if damaged, have the power tool repaired before use. Many accidents are caused by poorly maintained power tools.
6. Keep cutting tools sharp and clean. Properly maintained cutting tools with sharp cutting edges are less likely to bind and are easier to control.
7. Use the power tool, accessories and tool bits etc. in accordance with these instructions, taking into account the working conditions and the work to be performed. Use of the power tool for operations different from those intended could result in a hazardous situation.

Service

Have your power tool serviced by a qualified repair person using only identical replacement parts. This will ensure that the safety of the power tool is maintained.

Demolition Hammer Safety Warnings

1. Wear ear protectors. Exposure to noise can cause hearing loss.
2. Use auxiliary handles supplied with the tool. Loss of control can cause personal injury.
3. Hold power tools by insulated gripping surfaces when performing an operation where the cutting tool may contact hidden wiring or its own cord. Contact with a " live " wire will make exposed metal parts of the tool " live " and shock the operator.
4. Keep clear of moving parts.
5. Unplug before inspecting, removing or installing chisel, or performing any service.
6. Pull on chisel after installation and before use; chisel may move but must not slide out.
7. Wear steel-toed boots during use.
8. Do not operate this tool if you have back, neck, or wrist injuries, or other conditions that will be aggravated by the severe jerking forces that this tool exerts upon the operator.
9. Maintain labels and nameplates on the tool. These carry important safety information. If unreadable or missing, contact Tolsen Tools for a replacement.
10. Avoid unintentional starting. Prepare to begin work before turning on the tool.
11. Do not lay the tool down until it has come to a complete stop. Moving parts can grab the surface and pull the tool out of your control.
12. When using a handheld power tool, maintain a firm grip on the tool with both hands to resist starting torque.
13. Do not leave the tool unattended when it is plugged into an electrical outlet. Turn off the tool, and unplug it from its electrical outlet before leaving.
14. This product is not a toy. Keep it out of reach of children.
15. People with pacemakers should consult their physician(s) before use. Electromagnetic fields in close proximity to heart pacemaker could cause pacemaker interference or pacemaker failure. In addition, people with pacemakers should:
 - Avoid operating alone.
 - Properly maintain and inspect to avoid electrical shock.
 - Properly ground power cord. Ground Fault Circuit Interrupter (GFCI) should also be implemented it prevents sustained electrical shock.
16. The warnings, precautions, and instructions discussed in this instruction manual cannot cover all possible conditions and situations that may occur. It must be understood by the operator that common sense and caution are factors which cannot be built into this product, but must be supplied by the operator.

Vibration Safety

This tool vibrates during use. repeated or long-term exposure to vibration may cause temporary or permanent physical injury, particularly to the hands, arms and shoulders. to reduce the risk of vibration-related injury:

- 1.anyone using vibrating tools regularly or for an extended period should first be examined by a doctor and then have regular medical check-ups to ensure medical problems are not being caused or worsened from use. pregnant women or people who have impaired blood circulation to the hand, past hand injuries, nervous system disorders, diabetes, or raynaud's Disease should not use this tool. if you feel any symptoms related to vibration (such as tingling, numbness, and white or blue fingers), seek medical advice as soon as possible.
- 2.Do not smoke during use. nicotine reduces the blood supply to the hands and fingers, increasing the risk of vibration-related injury.
- 3.Wear suitable gloves to reduce the vibration effects on the user.
- 4.use tools with the lowest vibration when there is a choice.
- 5.include vibration-free periods each day of work.
- 6.Let the tool do the work. to reduce vibration, maintain the tool as explained in this manual. if any abnormal vibration occurs, stop use immediately



SAVE THESE INSTRUCTIONS.

SPECIFICATIONS

Electrical Input	230VAC / 50 Hz
No Load Blows Per Minute	1650 BPM
NPUT POWER	1700W
Impact Joules	60J
(30mm x 410mm) Chisels	1 Bull Point (included) 1 Flat Point (included)



Note: Symbology

	Certification company: BUREAU VERITAS
	Double Insulated
	WARNING mark concerning Risk of Eye Injury. Wear ANSI-approved safety goggles with side shields
	Read the manual before set-up and/or use.
	Faulty and/or discarded electrical or electronic have to be collected all the appropriate recycling locations.

SETUP - BEFORE USE:



Read the **ENTIRE IMPORTANT SAFETY INFORMATION** section at the beginning of this manual including all text under subheadings therein before set up or use of this product.

Assembly

The only assembly required for the Demolition Hammer is the positioning of the Auxiliary Handle around the Cylinder Case.

1. Twist Auxiliary Handle into desired position.
2. Tighten Auxiliary Handle Knob to
3. fasten Auxiliary Handle in place.

FUNCTIONS

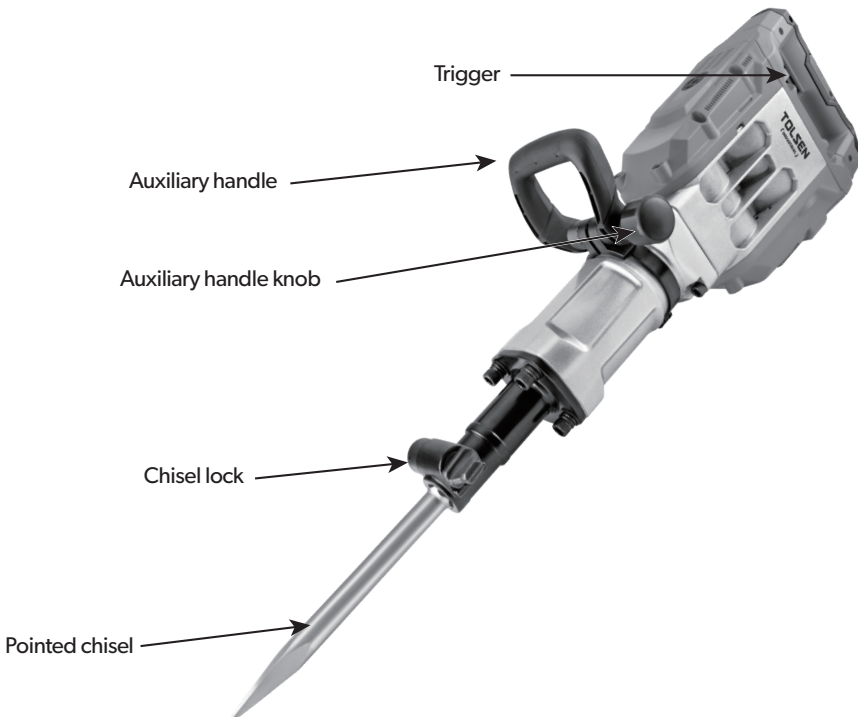

OPERATING INSTRUCTIONS



Read the **ENTIRE IMPORTANT SAFETY INFORMATION** section at the beginning of this manual including all text under subheadings therein before set up or use of this product.

Tool Set up

WARNING

To prevent serious injury from accidental operation:

Make sure that the trigger is in the off-position and unplug the tool from its electrical outlet before performing any procedure in this section. Chisels come with or without collars. **cautiOn!** Chisel may be HOT after use.

Avoid contact Figure B shows installation of a chisel without a collar with skin and use protective gloves to remove. (the included chisel is without a collar).

Mounting chisels without a collar

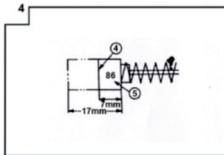
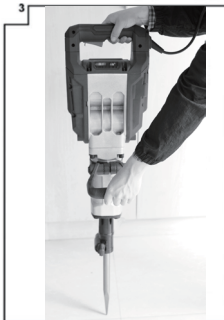
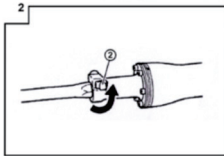
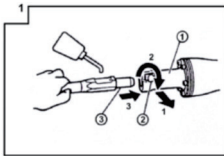

1	Front cover
2	Stop lever
3	Tool shank
4	Wear limit
5	No.of carbon brush

Important: carefully read the instructions in this manual as well as the general safety instructions before using this tool.

Work piece and Work area Set up

1. Designate a work area that is clean and well-lit. The work area must not allow access by children or pets to prevent distraction and injury.
2. Route the power cord along a safe route to reach the work area without creating a tripping hazard or exposing the power cord to possible damage. The power cord must reach the work area with enough extra length to allow free movement while working.
3. There must not be objects, such as utility lines, nearby that will present a hazard while working.

General Operating instructions

1. Make sure that the Trigger is in the off-position, then plug in the tool.
2. Once the chisel is installed and the Auxiliary Handle set in the desired position, set the tip of the bit against the work area.
3. Place one hand on the Auxiliary Handle and the other hand around the Main Handle.
4. Press the Trigger to activate the Demolition Hammer.
5. **WARNING!** Once activated, do not press, bear down or thrust forcibly against the work surface. Hold the Demolition Hammer with just enough pressure so that the tool's own weight supplies the needed force.
6. When work is complete, release the Trigger.
7. To prevent accidents, turn off the tool and disconnect its power supply after use. Clean, then store the tool indoors out of children's reach.

NOTE: If the Demolition Hammer has not been used for a long period of time or is being used in low temperatures, the tool should run for about two minutes before achieving full performance.

Make sure the Trigger properly actuates when pressed and that the tool turns off when its released.

NOTE: Avoid operating the tool without pressing the bit against an object. Doing so will damage the tool.

MAINTENANCE AND SERVICING

 procedures not specifically explained in this manual must be performed only by a qualified technician.

Note: the Demolition Hammer will cease operation once carbon Brushes are worn. check Brushes every 100-120 hours and, when necessary, replace them.

WARNING

TO PREVENT SERIOUS INJURY FROM ACCIDENTAL OPERAITON:

Make sure that the trigger is in the off-position and unplug the tool from its electrical outlet before performing any procedure in this section.

TO PREVENT SERIOUS INJURY FROM TOOL FAILURE:

Do not use damaged equipment. if abnormal noise or vibration occurs, have the problem corrected before further use.

Cleaning and Maintenance

1. BEFORE EACH USE, inspect the general condition of the tool. Check for:

- loose hardware,
- misalignment or binding of moving parts,
- damaged cord/electrical wiring,
- dull or cracked Chisel,
- cracked or broken parts, and
- any other condition that may affect its safe operation.

2. AFTER USE, wipe external surfaces of the tool with clean cloth.

3. This Tool comes properly lubricated. Internal lubrication is only needed when replacing the Carbon Brushes, see below.

Note: the Demolition Hammer has airtight construction, allowing three months of continuous usage before lubrication is needed.

4. Store in temperatures no lower than 50-60° F.

5.  **WARNING** if the supply cord of this power tool is damaged, it must be replaced only by a qualified service technician.

TROUBLESHOOTING

problem	possible causes	Likely Solutions
Tool will not start.	<ol style="list-style-type: none"> 1.Cord not connected. 2.No power at outlet. 3.Tool's thermal reset breaker tripped (if equipped). 4.Internal damage or wear. (Carbon brushes or Trigger, for example.) 	<ol style="list-style-type: none"> 1.Check that cord is plugged in. 2.Check power at outlet. If outlet is unpowered, turn off tool and check circuit breaker. If breaker is tripped, make sure circuit has right capacity for tool and circuit has no other loads. 3.Turn off tool and allow to cool. Press reset button on tool. 4.Have technician service tool.
Tool operates slowly.	Extension cord too long or wire size too small.	Eliminate use of extension cord. If an extension cord is needed, use shorter/heavier gauge cord. See Extension Cords in GROUNDING section.
Performance decreases over time.	<ol style="list-style-type: none"> 1.Chisel dull or damaged. 2.Internal lubrication cold. 3.Carbon brushes worn or damaged. 	<ol style="list-style-type: none"> 1.Keep cutting chisels sharp. Replace as needed. 2.Allow tool to operate with no load for 2minutes before use. 3.Have qualified technician replace brushes.
Excessive noise or rattling.	Internal damage or wear. (Carbon brushes or bearings, for example.)	Have technician service tool.
Overheating.	<ol style="list-style-type: none"> 1.Forcing tool to work too fast. 2.Chisel dull or damaged. 3.Blocked motor housing vents. 4.Motor being strained by long or small diameter extension cord. 	<ol style="list-style-type: none"> 1.Allow tool to work at its own rate. 2.Keep cutting chisels sharp. Replace as needed. 3.Wear ANSI-approved safety goggles and NIOSH-approved dust mask/respirator while blowing dust out of motor using compressed air. 4.Eliminate use of extension cord. If an extension cord is mneeded, use one with the proper diameter for its length mand load. See Extension Cords in GROUNDING section.



Follow all safety precautions whenever diagnosing or servicing the tool. Disconnect power supply before service.

CE DECLARATION OF CONFORMITY

WE
SUZHOU TOLSEN TOOLS CO.,LTD.
198 HUASHAN ROAD, ZHANGJIAGANG,
JIANGSU, CHINA

Declare that the product
88553 DEMOLITION HAMMER
Hand Held Electric Chisel (Electric Chisel)

Complies with the essential health and safety requirements of the following

Directices:

EC Council Directive 2006/42/EC Machinery

Standards and technical specifications referred to:

EN 60745-1:2009+A11

EN 60745-2-6:2010

EN 55014-1:2017+A11

EN 55014-2:2015

EN IEC 61000-3-2:2019

EN IEC 61000-3-11:2019

Authorised Signatory and technical file holder

Signed for and on behalf of:

SUZHOU TOLSEN TOOLS CO.,LTD.
198 HUASHAN ROAD, ZHANGJIAGANG,
JIANGSU, CHINA
ZHANG XING YU
Group Quality Director

on:26/05/2020

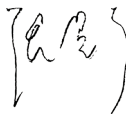

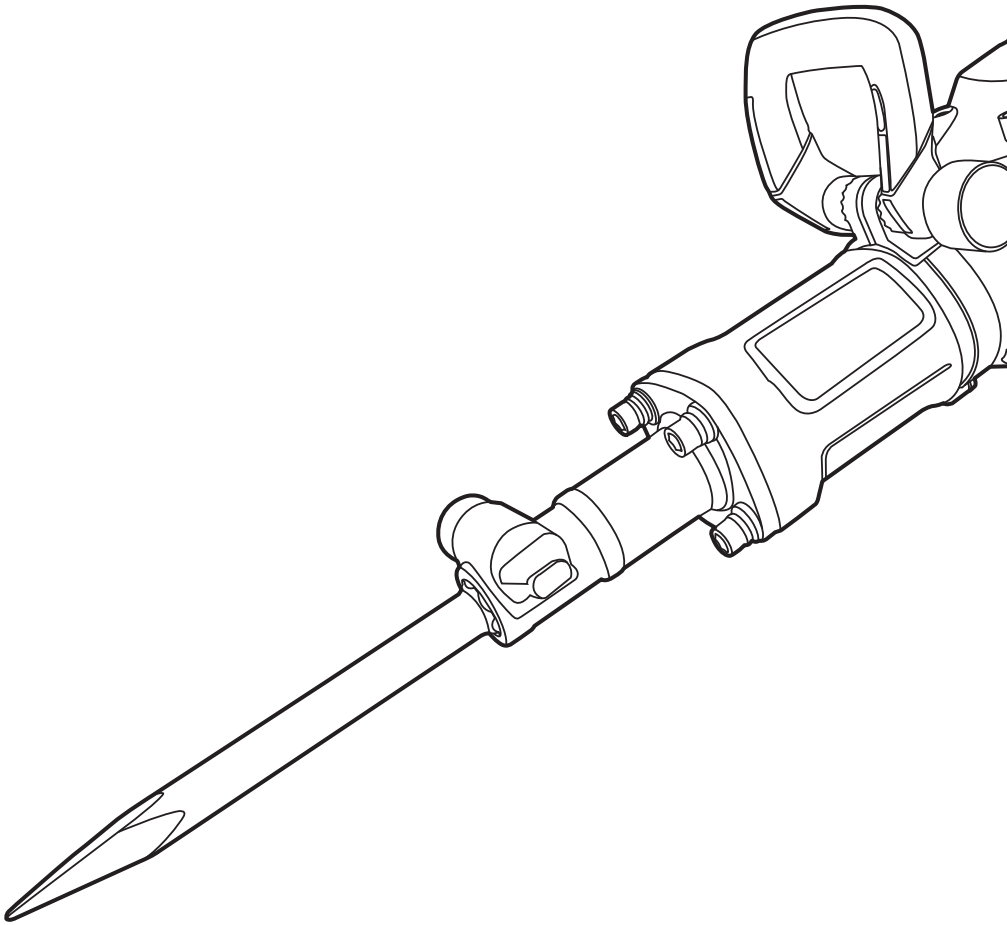

**SUZHOU TOLSEN
TOOLS CO.,LTD.**

www.tolsentools.com

TOLSEN is a trademark or
registered trademark of TOLSEN
TOOLS. All rights reserved.
MADE IN CHINA



SCAN TO VISIT
PRODUCT LINK